

# WaterTec Dust

## Cast Iron Gate Valve

### Model 115 FL NRS AWWA C-515 ANSI 125# Flange (FL)

#### FEATURES:

Sizes: 2½" - 16"

Max. working water pressure 250 PSI (1723 kPa)  
 Max. working water temperature 140°F (82°C)  
 Hydrostatic test pressure 400 PSI (2758 kPa)  
 End connection ANSI/ASME B16.1  
 Optional hand wheel add "HW" to end of part #

#### STANDARDS COMPLIANCE:

- AWWA Compliant C515



#### MATERIALS:

Valve Body & Ductile Iron ASTM A536 Gr 65-45-12  
 Covers

Coating AWWA compliant C550

Wedge Ductile Iron ASTM A536 Gr 65-45-12  
 With EPDM coating

Elastomers EPDM

Fasteners Zinc plated steel ASTM A307 Grade B &  
 304 Stainless Steel

Stem 420 Stainless Steel

Standard 2" Operating Nut, Wheel optional

#### APPLICATION:

Designed for installation on potable water lines, irrigation systems, waterworks connections and fire systems.

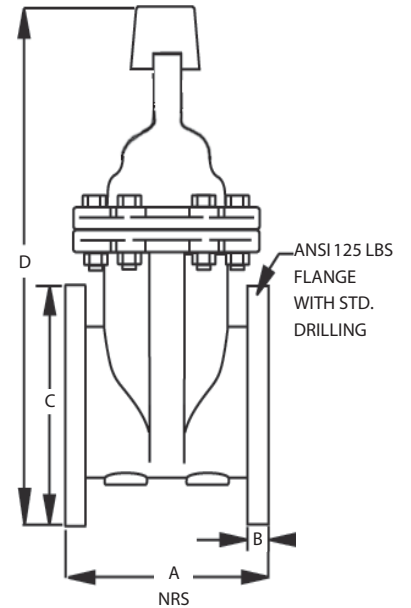

Size		Part#	A		B		C		D		Weight	
Inch	mm		Inch	mm	Inch	mm	Inch	mm	Inch	mm	lbs	kg
2-1/2	65	8561	7-1/2	191	11/16	18	7	178	14-7/8	378	38	17.2
3	80	8562	8	203	3/4	19	7-1/2	191	16-1/8	410	56	25.4
4	100	8563	9	229	15/16	24	9	229	19-1/4	489	78	35.4
6	150	8564	10-1/2	267	1	25	11	279	24-1/2	622	138	62.75
8	200	8565	11-1/2	292	1-1/8	29	13-1/2	343	29-1/4	743	214	97.25
10	250	8566	13	330	1-3/16	30	16	406	34-1/2	876	360	163.5
12	300	8567	14	356	1-1/4	32	19	483	39-1/2	1003	531	241
14	350	8568	15	381	1-1/4	32	21	533	43-3/8	1102	547	248
16	400	8569	16	406	1-19/64	33	23-1/2	597	49-1/4	1252	719	326